

# WHEEL FITMENT TEMPLATES

ACURA	INTEGRA DC2 TYPE-R	98~00	
PARTS NO.	ROTOR DIAMETER	FRONT/REAR	PCD
HO09-1-7	330X 32	FRONT	5 X 114.3

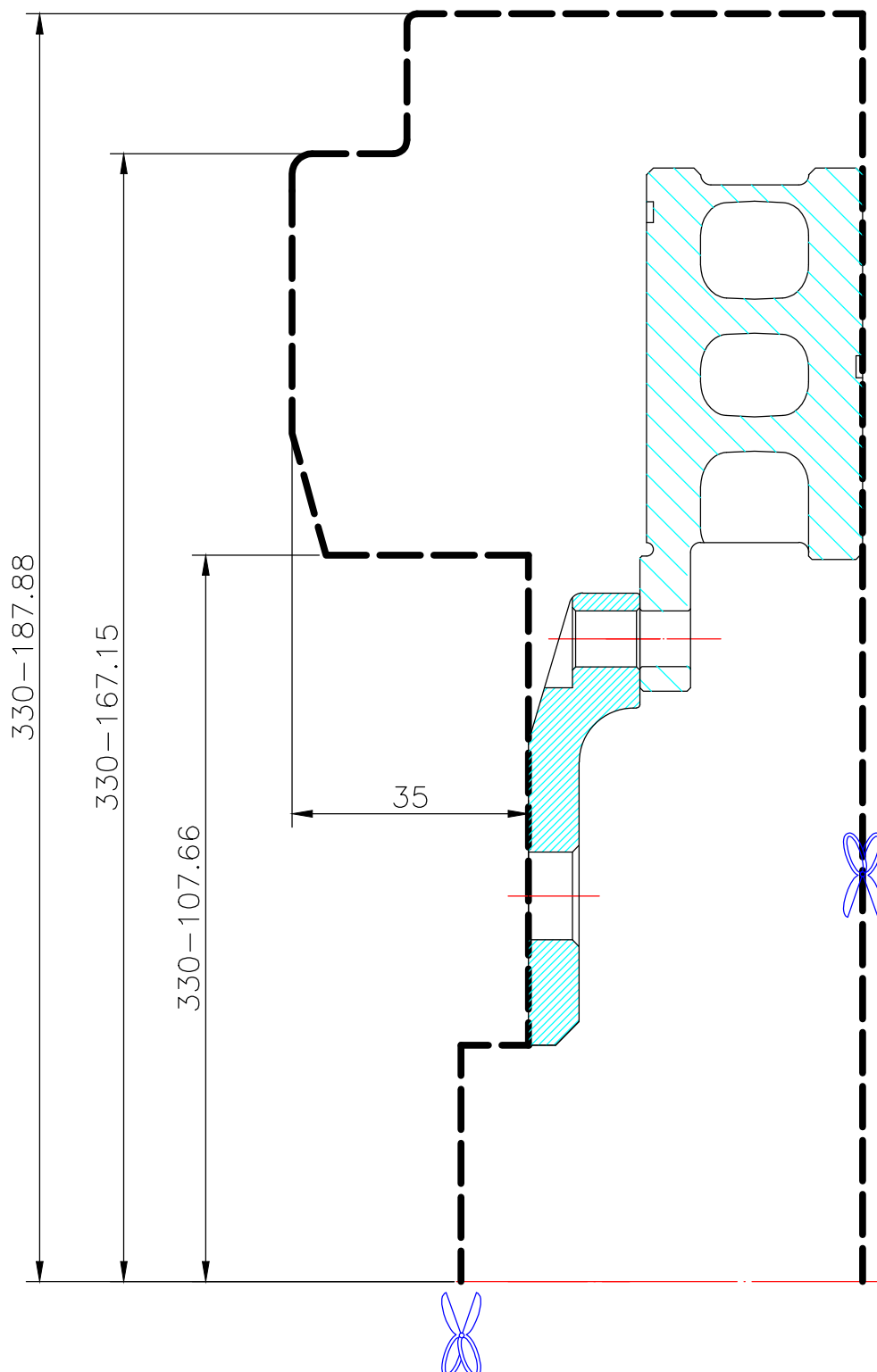

The wheel fitment is only for your reference and it can not 100% ensure the clearance between caliper and rim is ok. if there is any interference issue, please change your wheel as possible.