

# WHEEL FITMENT TEMPLATES

NISSAN	TIDA C11	04~12	
<b>PARTS NO.</b>	<b>ROTOR DIAMETER</b>	<b>FRONT/REAR</b>	<b>PCD</b>
NI23-7	304 X 28	FRONT	4 X 114.3

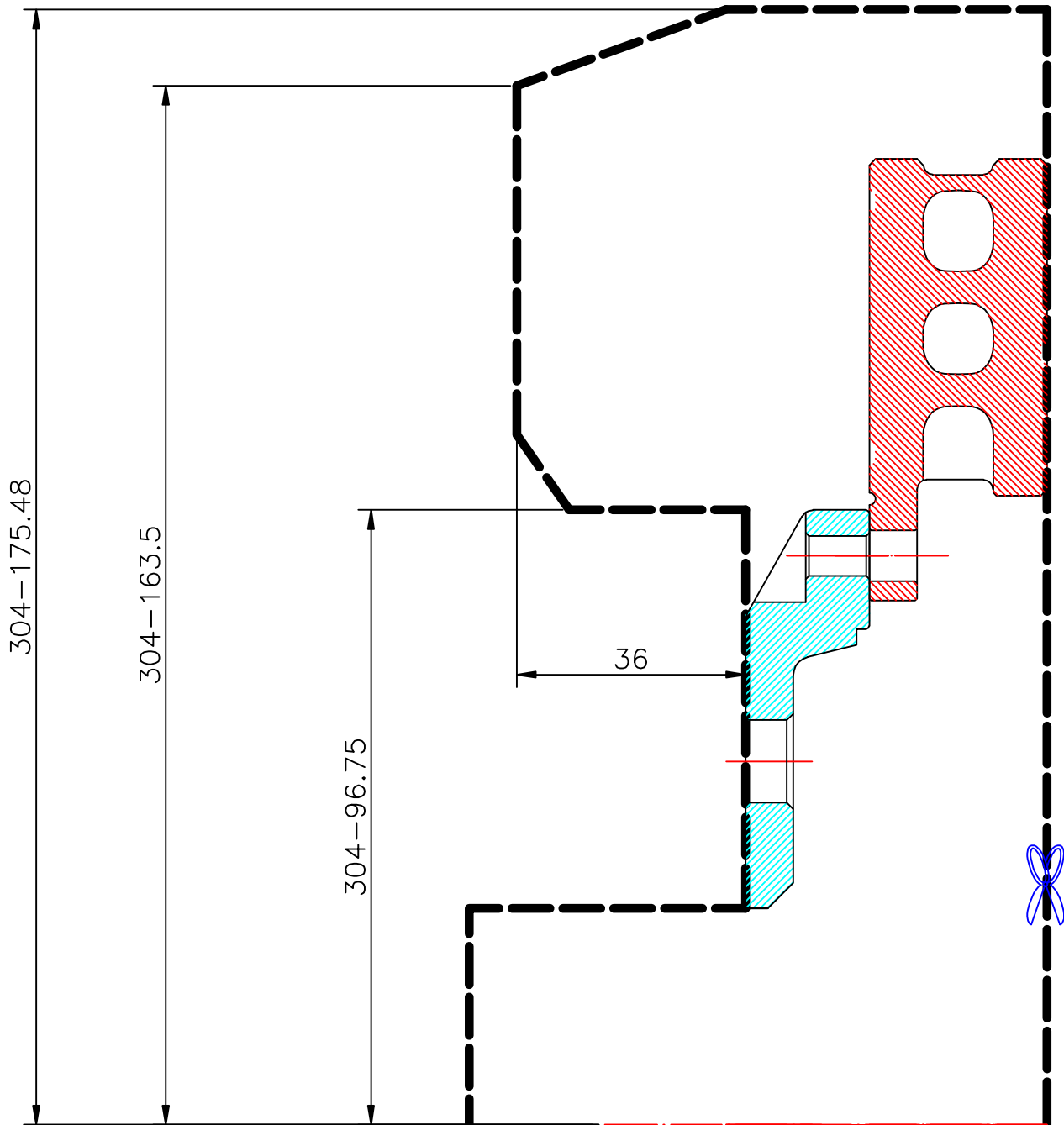

**The wheel fitment is only for your reference and it can not 100% ensure the clearance between caliper and rim is ok. if there is any interference issue, please change your wheel as possible.**