

WHEEL FITMENT TEMPLATES

TOYOTA	ALPHARD III (AH30)	15~UP	
PARTS NO.	ROTOR DIAMETER	FRONT/REAR	PCD
TO32-1-7	304mm X 28mm	FRONT	5 X 114.3

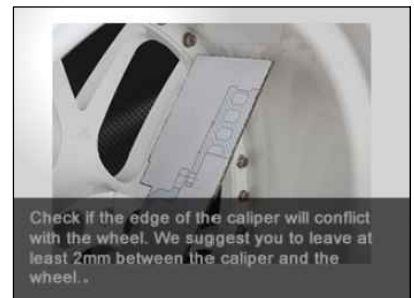
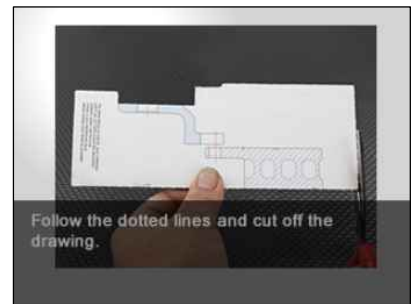
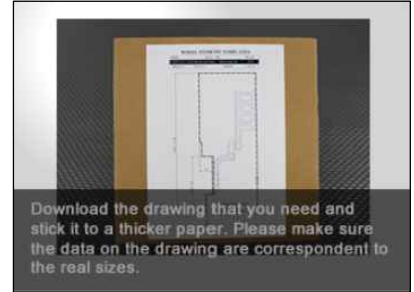
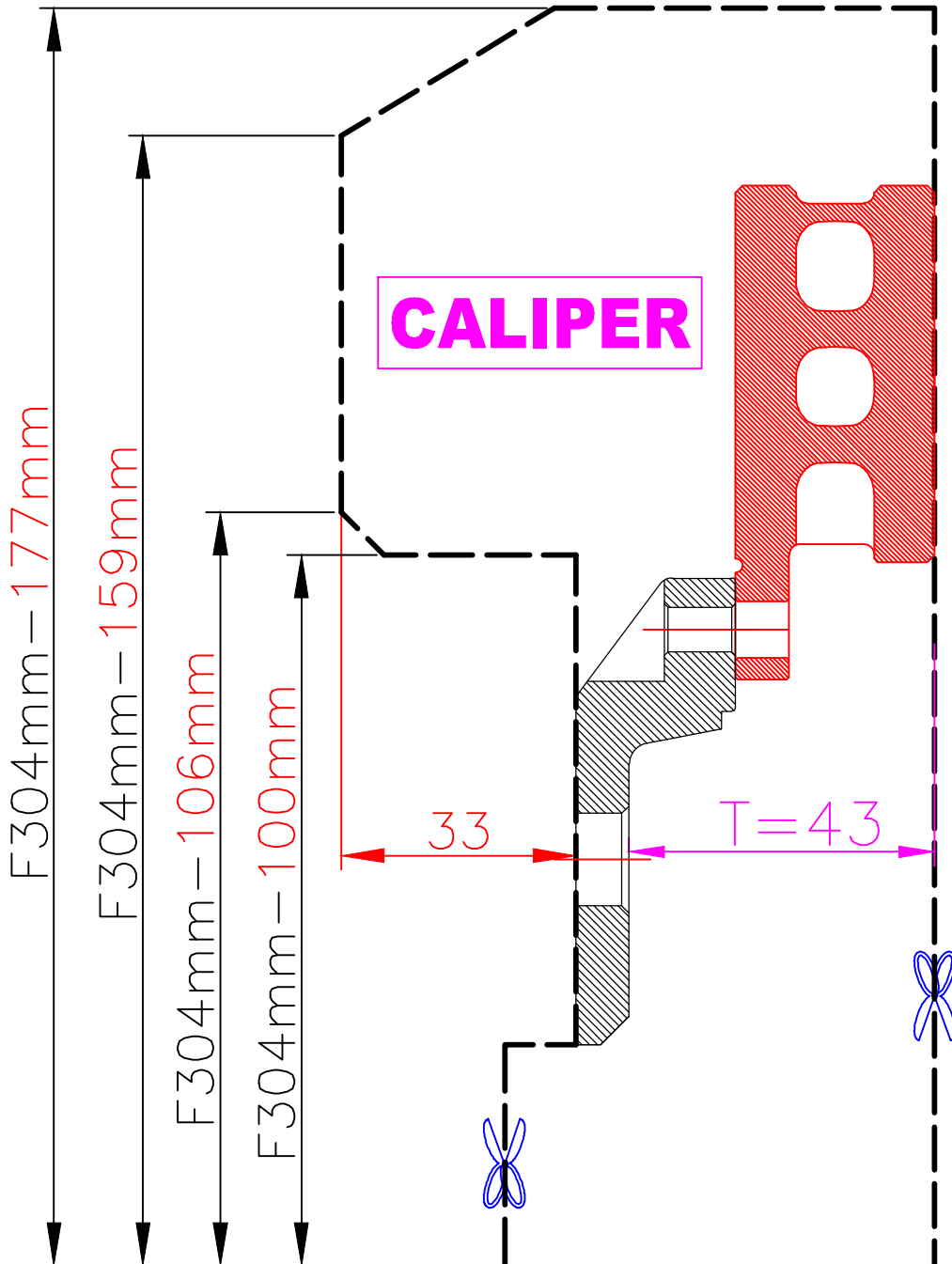

The wheel fitment is only for your reference and it can not 100% ensure the clearance between caliper and rim is ok. if there is any interference issue, please change your wheel as possible.