

# WHEEL FITMENT TEMPLATES

NISSAN		SKYLINE R35 GTR		09~UP	
PARTS NO.	ROTOR DIAMETER	FRONT/REAR	PCD		
NI42	421mm X 36mm	FRONT	5X114.3		

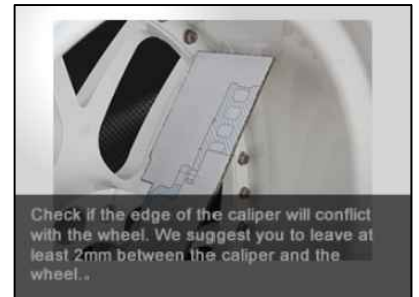
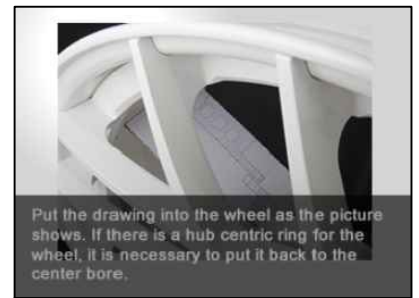
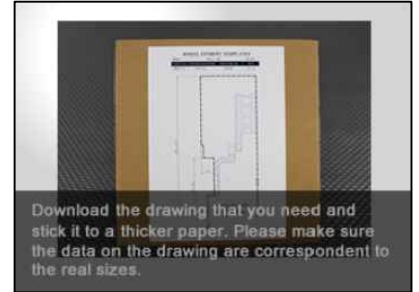
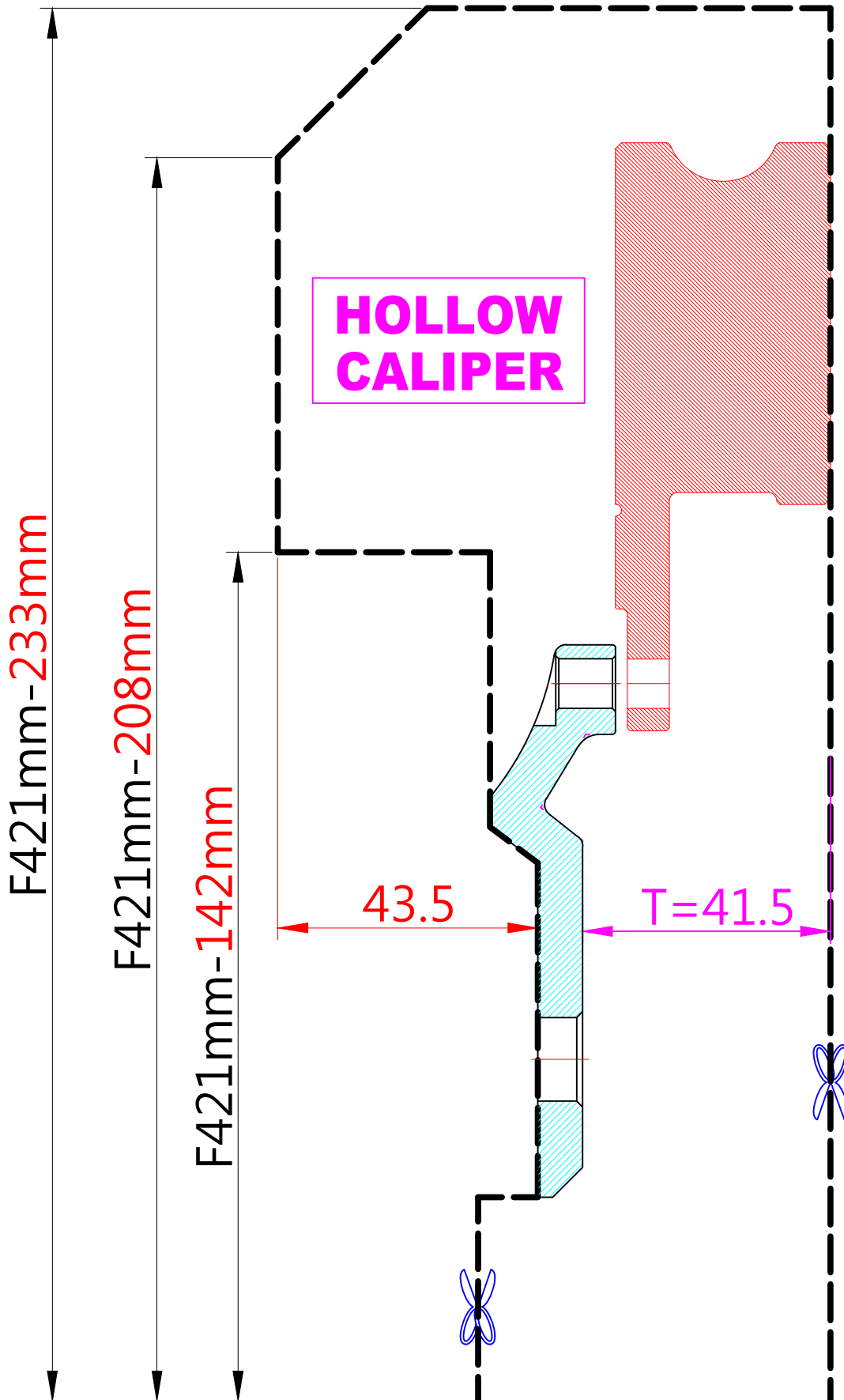

The wheel fitment is only for your reference and it can not 100% ensure the clearance between caliper and rim is ok. if there is any interference issue, please change your wheel as possible.